

COX CREEK MEADOW
FLOW ENHANCEMENT
POND

HUMBOLDT COUNTY, CA

Stillwater Sciences

850 G STREET SUITE K
ARCATA, CA 95521 P: (707) 822-9607

22' THICK DOWNSTREAM BERM, <25' HEIGHT TO AVOID DSOD JURISIDICION
8' CUT BENCH
2.5:1 CUTS, 3:1 FILLS EXCEPT WHERE NOTED
44,200 CY CUT, 16,100 FILL, NET:28,100 CUT
8.585 MILLION GALLONS VOLUME AT 2' FREEBOARD

ROCK ARMORED SPILLWAY. CREST
SET 2' BELOW BERM ELEVATION

EXISTING ROAD

CLASS III WATERCOURSE

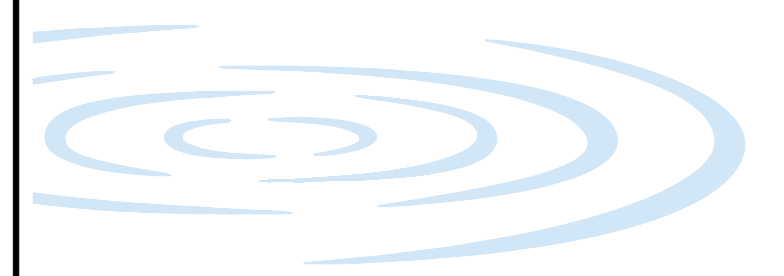
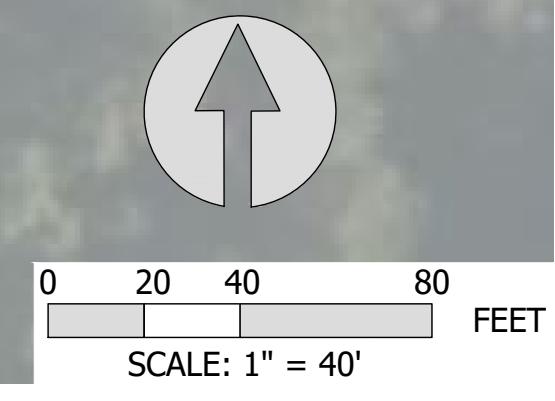

PROJECT NUMBER: 603.03
SCALE: AS NOTED
DATE: 11/2/2021

DESIGN: JM
DRAWN: TC
CHECKED: ----
APPROVED: ----

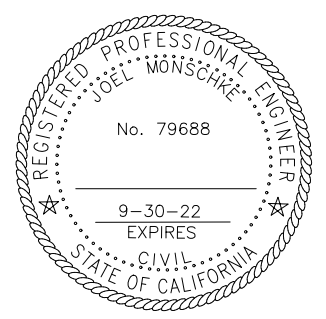

PLAN VIEW (IMAGERY)

SHEET 1 OF 3

IF BAK DOES NOT MEASURE, DRAWING IS NOT TO SCALE - ADJUST ACCORDINGLY
LAST SAVED: 11/2/2021 11:22:20 AM PLOT DATE: 11/2/2021 PLOT STYLE: -----
C:\USERS\TECHNINGS\HAM\DESKTOP\PROJECTS\11_PROJECTS\SPRINT\COX_CREEK_WATERSHED_ASSESSMENT\ARCATA\2_MODEL\A\COX_MEADOW_FLOW_ENHANCEMENT_V2_11-2_2021_RECOVER.DWG

**COX CREEK MEADOW
FLOW ENHANCEMENT
POND**

HUMBOLDT COUNTY, CA

Stillwater Sciences

850 G STREET SUITE K
ARCATA, CA 95521 P: (707) 822-9607

22' THICK DOWNSTREAM BERM, <25' HEIGHT TO AVOID DSOD JURISIDICION
8' CUT BENCH
2.5:1 CUTS, 3:1 FILLS EXCEPT WHERE NOTED
44,200 CY CUT, 16,100 FILL, NET:28,100 CUT
8.585 MILLION GALLONS VOLUME AT 2' FREEBOARD

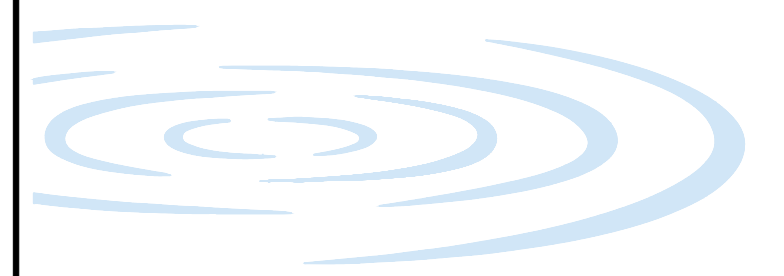
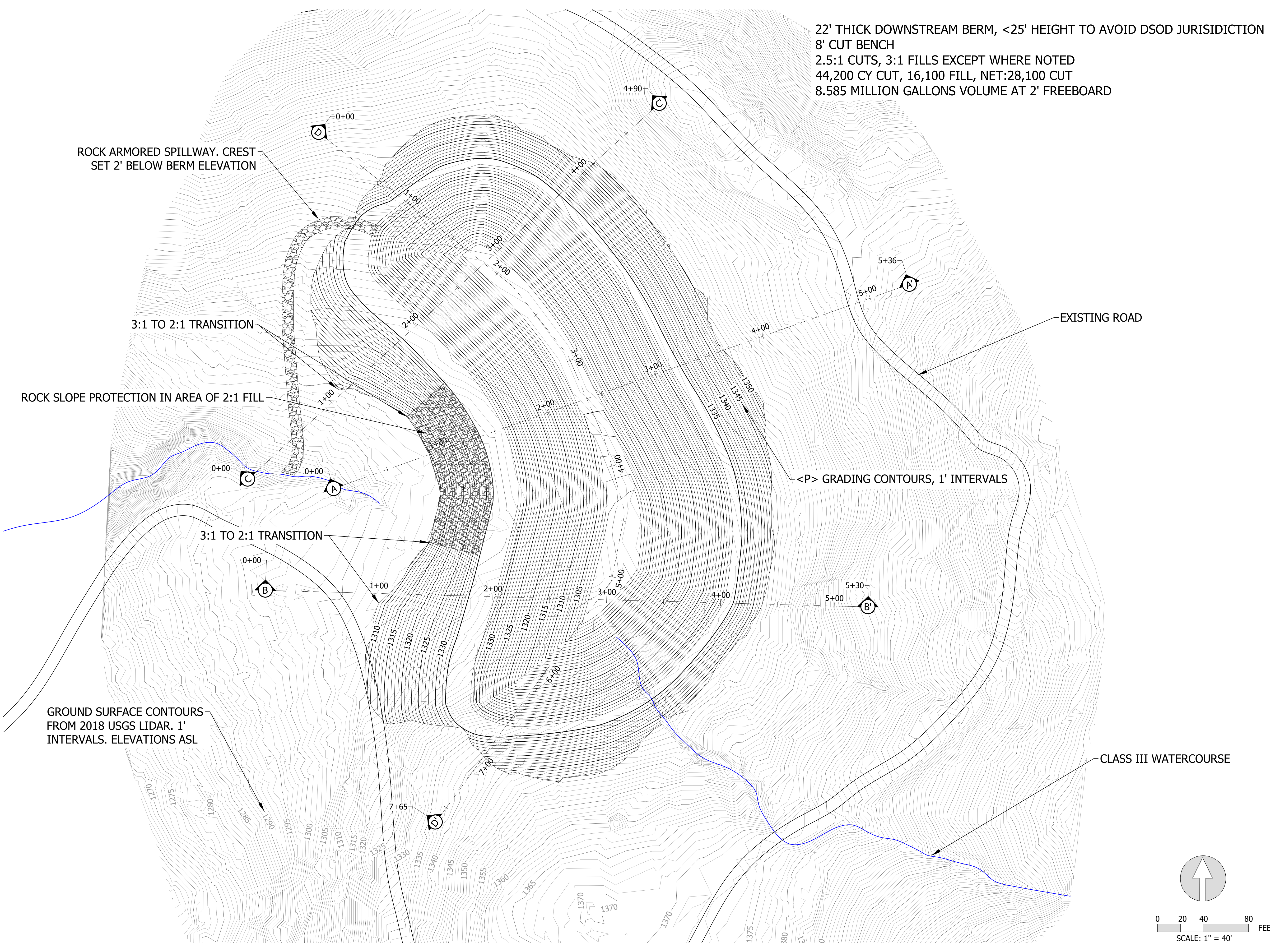

PROJECT NUMBER: 603.03
SCALE: AS NOTED
DATE: 11/2/2021

DESIGN: JM
DRAWN: TC
CHECKED: ----
APPROVED: ----

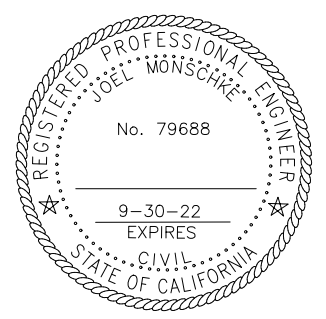

PLAN VIEW

SHEET 2 OF 3

LAST SAVED: 11/2/2021 PLOT DATE: 11/2/2021 PLOT STYLE: -----
 C:\USERS\TECHNICAL\WORKSPACE\PROJECTS\COX_CREEK_WATERSHED_ASSESSMENT\ARCATA\X_MODELS\C03 MEADOW GRADING V2 11-2_RECOVER.LWG

COX CREEK MEADOW
FLOW ENHANCEMENT
POND

HUMBOLDT COUNTY, CA

Stillwater Sciences

850 G STREET SUITE K
ARCATA, CA 95521

P: (707) 822-9607

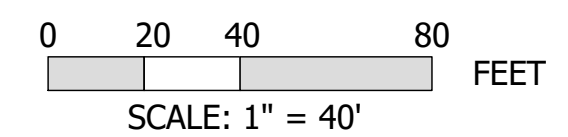
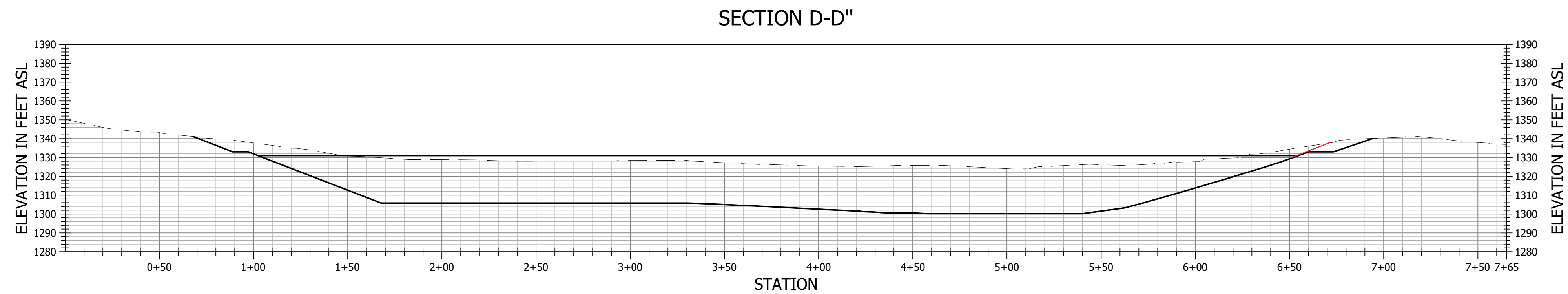
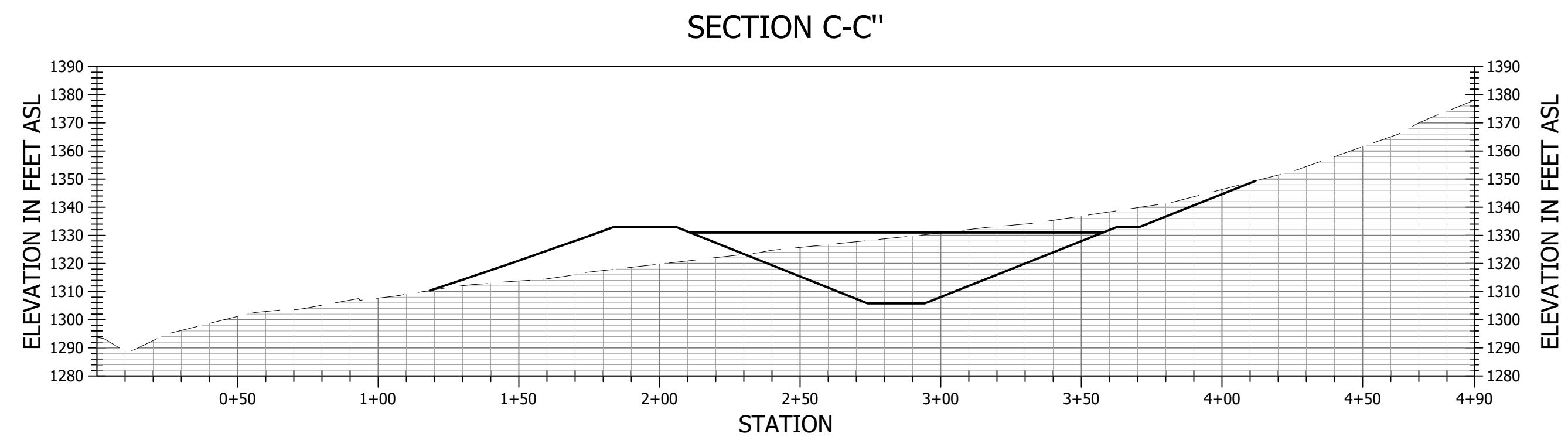
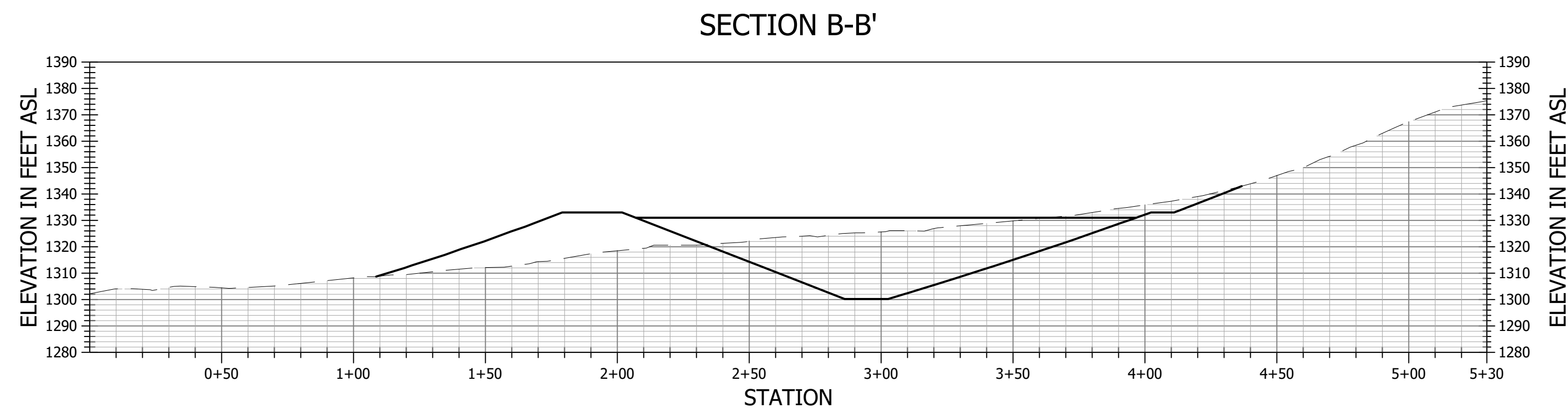
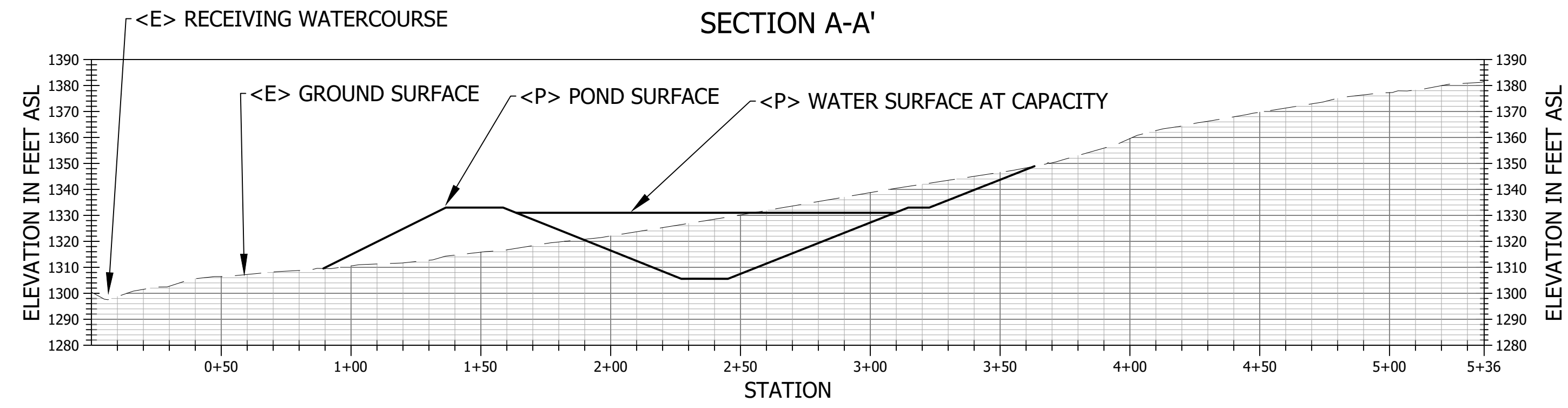

PROJECT NUMBER: 603.03

SCALE: AS NOTED

DATE: 11/2/2021

DESIGN: JM

DRAWN: TC

CHECKED: ----

APPROVED: ----



PROFILE VIEWS

SHEET 3 OF 3

LAST SAVED: 11/2/2021 11:22:21 AM PLOT DATE: 11/2/2021 PLOT STYLE: -----
 C:\USERS\JGONING\WORKSPACE\PROJECTS\COX_CREEK_WATERSHED_ASSESSMENT\ARCATA\MODELS\MEADOW_GRADING_V2_11-2_2021.DWG

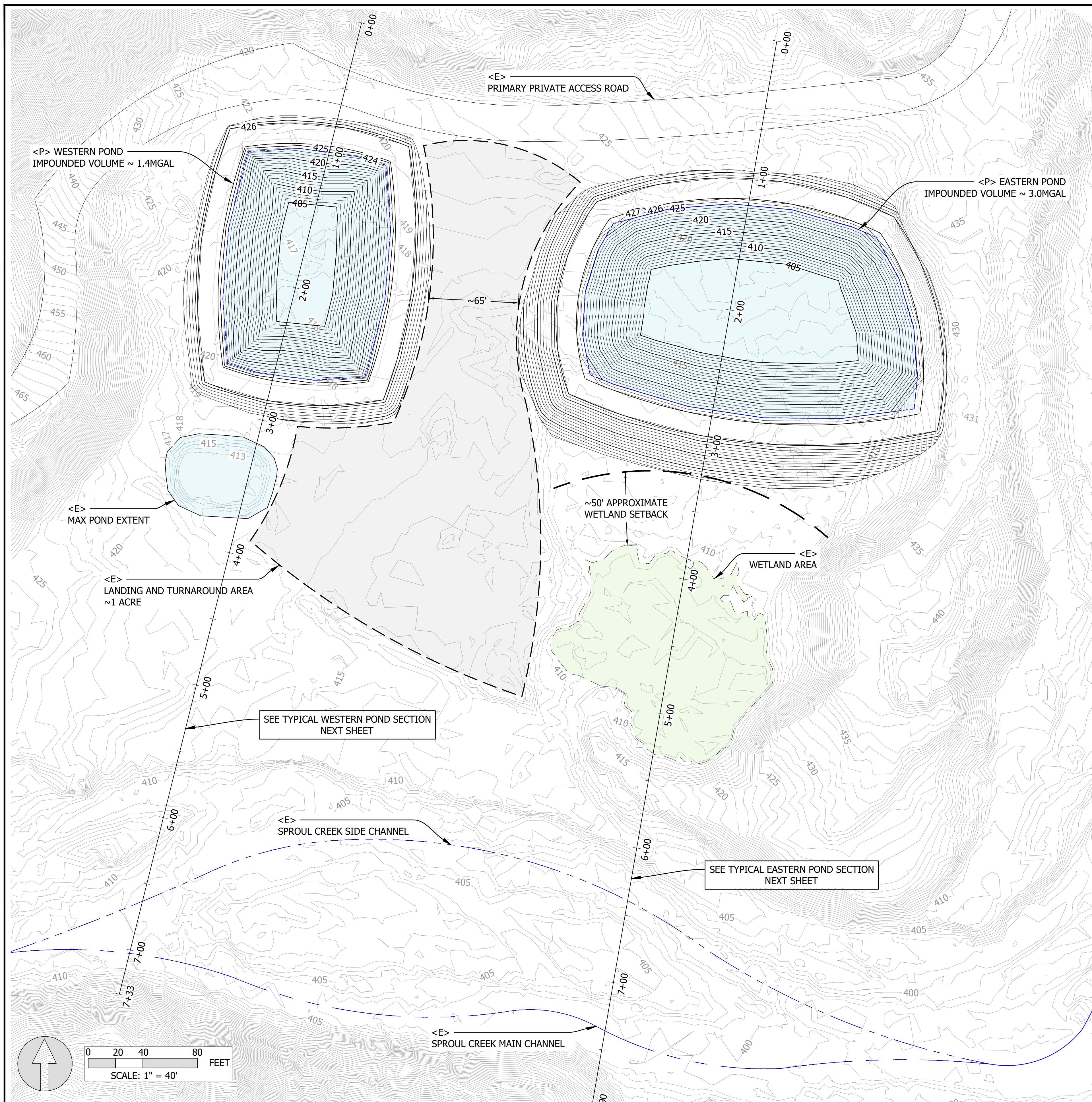

PROJECT OBJECTIVE:
 MULTI-BENEFIT OFF-STREAM PONDS TO SUPPLY WATER FOR: WATERING ROADS, FIRE SUPPRESSION, AND FLOW AUGMENTATION.
 FLOW AUGMENTATION RELEASE FROM BOTH PONDS VIA VALVED PIPES INTO WETLAND FOR, PASSIVE FILTRATION AND COOLING DURING CONVEYANCE TO SPROUL CREEK THROUGH EXISTING GROUNDWATER CONNECTION.

<P> WESTERN POND DESIGN DETAILS
 ALL SIDE SLOPES AT ~2:1 (H:V);
 ~15' WIDE BERM WITH CREST AT ~426' MAX ELEV; PROVIDE ~3% CROSS SLOPE INWARD;
 SET POND BOTTOM AT ~405' AND PROVIDE CONTINUOUS LINER WITHIN BASIN;
 PROVIDE ~2' OF FREEBOARD TO PRODUCE A MAX POND DEPTH OF ~19';
 EARTHWORK BALANCES ONSITE AT ~4,000 CYD;
 IMPOUNDED VOLUME ~ 1.43 MILLION GALLONS

<P> EASTERN POND DESIGN DETAILS
 ALL SIDE SLOPES AT ~2:1 (H:V);
 ~15' WIDE BERM WITH CREST AT ~427' MAX ELEV; PROVIDE ~3% CROSS SLOPE INWARD;
 SET POND BOTTOM AT ~405' AND PROVIDE CONTINUOUS LINER WITHIN BASIN;
 PROVIDE ~2' OF FREEBOARD TO PRODUCE A MAX POND DEPTH OF ~20';
 EARTHWORK BALANCES ONSITE AT ~8,500 CYD;
 IMPOUNDED VOLUME ~3.00 MILLION GALLONS

SPROUL CREEK FLOW ENHANCEMENT PONDS FEASIBILITY AND SIZING
 HISTORIC MILL SITE, GREEN DIAMOND PROPERTY

Stillwater Sciences
 2855 TELEGRAPH AVENUE, SUITE 400
 BERKELEY, CA 94705 P: (510) 848-8098

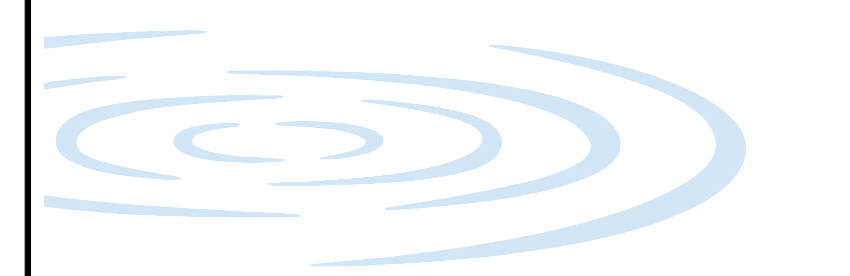

PROJECT NUMBER: 603.3
SCALE: AS NOTED
DATE: 11/29/21

DESIGN: JM/BW
DRAWN: BW
CHECKED: JM
APPROVED: JM

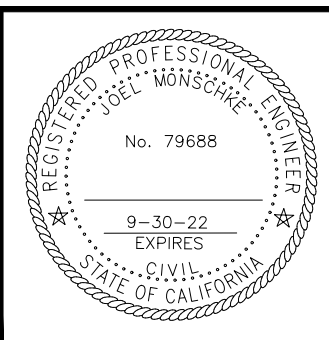

PROPOSED POND OVERVIEW SHEET

LAST SAVED: 11/29/2021 PLOT DATE: 11/29/2021 PLOT STYLE: ----- PLOT: BARRIERS NOT MEASURED. T. FORMS IS NOT TO SCALE. ADJUST ACCORDINGLY.

SPROUL CREEK FLOW
ENHANCEMENT PONDS
FEASIBILITY AND SIZING
HISTORIC MILL SITE,
GREEN DIAMOND PROPERTY

Stillwater Sciences

2855 TELEGRAPH AVENUE, SUITE 400
BERKELEY, CA 94705 P: (510) 848-8098

WESTERN POND TYPICAL SECTION

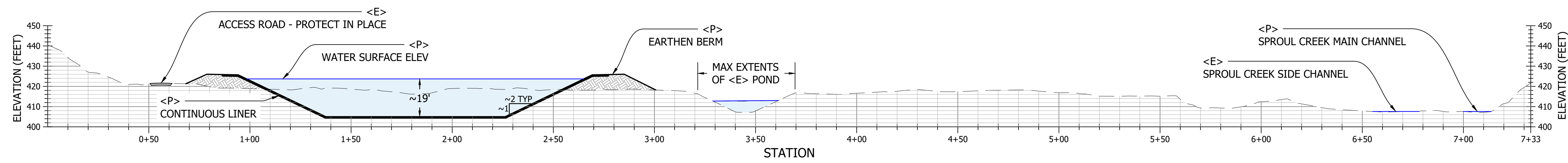

EASTERN POND TYPICAL SECTION

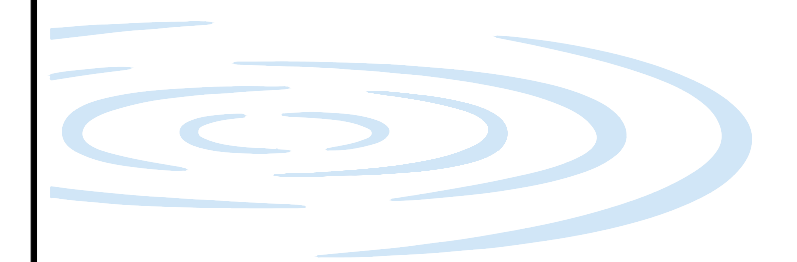
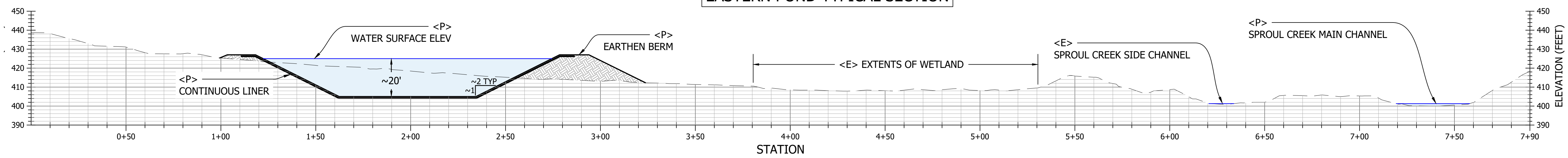

PROJECT NUMBER: 603.3

SCALE: AS NOTED

DATE: 11/29/21

DESIGN: JM/BW

DRAWN: BW

CHECKED: JM

APPROVED: JM

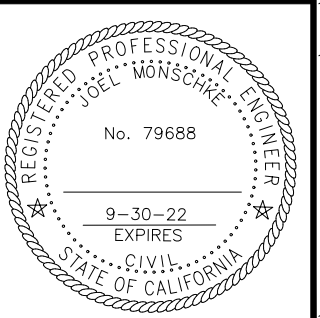

PROPOSED POND
TYPICAL SECTIONS SHEET

SHEET 2 OF 2

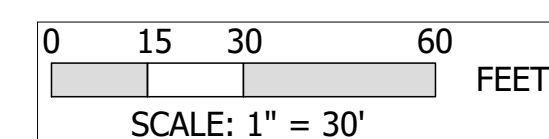
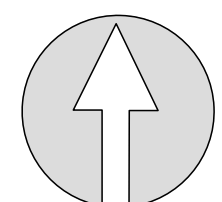

1

PROPOSED PONDS AT HISTORIC MILL SITE - TYPICAL SECTIONS
Scale: 1:30 - NO VERTICAL EXAGGERATION

LAST SAVED: 11/29/2021 11:29:21 AM PLOT DATE: 11/29/2021 PLOT STYLE: s...
 C:\CONSERVATION\DRAWING - STILLWATER SCIENCES\603.3 - SPROUL CREEK FLOW ENHANCEMENT POND\ACAD\2 - MODEL\603.3 - SPROUL CREEK FLOW ENHANCEMENT POND\CONCEPT.DWG